

IMPORTANT INFORMATION

Carefully read the enclosed installation instructions before installation. When installing the product, warnings and general instructions must be followed. All enclosed documentation must be provided to the user by the installer.

Before installation, ensure that the door and frame are in good condition and that the correct door hanging and fittings match.

Check that the door construction permits the use of electric locks. Can be used in double swinging doors if the door's construction permits the use of electric locks. Depending on the type of door (wood, steel or aluminium), different installation methods may be needed (angle bracket or screw). When installing in pair doors with a door closer, check whether a door coordinator is required.

During installation, other fittings, e.g. sealing strips, must be handled with care so that the function of neither the electrical lock nor other fittings are affected. Ensure that the recess corresponds to the dimensional drawing of the lock and the hook.

After installation, make sure that all screws are tightened. Care shall be taken to ensure that no projection of the bolt heads, when in the withdrawn position, can prevent the door swinging freely.

The security characteristics of this product are crucial for its compliance with EN 14846.

No changes of any kind, other than those described in these instructions, are permitted.

	Stendals EL AB Signalistgatan 17 721 31 Västerås, Sweden					
	0402 - 8-01					
STEP 8						
EN 14846:2008	3	X	8	0	-	M 3 0 1

CONTACT US

Remember that you are always welcome to contact us if you need any help. Email or call our technical support at info@steplock.se or +46 21-480 12 13.



STEP LOCK

When it has to work.

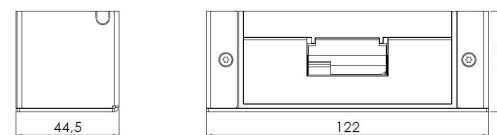

STEP 8 without angle bracket.

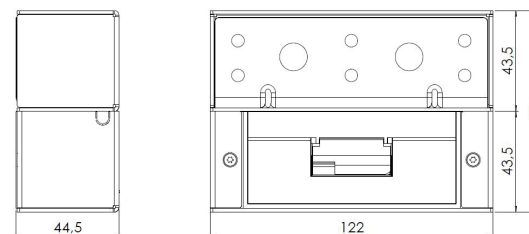

STEP 8 with angle bracket with house.

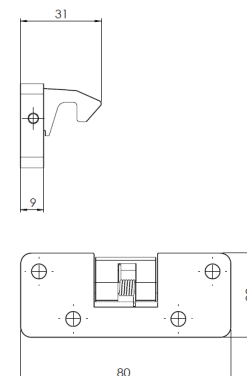

Hook

Installation instructions STEP 8™

2021, version 1

INSTALLATION INSTRUCTIONS

- Connect the plugs in the screw terminal block.
- Use the attached drill template to pre-drill holes in the frame.
- Mount STEP 8 with the attached screws.
- Mount the hook with the attached screws.
- Ensure that there is a gap between the lock's cylinder latch and the hook of 1 mm ± 0.5 mm.

Note that STEP 8 must not be overpainted.

MAINTENANCE INSTRUCTIONS

- Regularly check the operation of the surface mounted electric lock and hook, and its attachment to the frame.
- Twice a year, or when necessary, the rotating cam must be lubricated with lock grease (see figure). Use a thin layer of DIN 51502 grease.
- Note that STEP 8 must never be lubricated with oil.

POWER CONSUMPTION AND WIRING DIAGRAM

Power consumption 24 V DC	Power consumption 12 V DC
0 mA with rotating cam in standby	0 mA with rotating cam in standby
110 mAh at unlocked (fail secure) / locked (fail safe)	220 mAh at unlocked (fail secure) / locked (fail safe)

Max. 300 mA at 24 V DC / 600 mA at 12 V DC for 0.2 seconds to fulfil the need for locking or unlocking upon special events.

Contact us in the event of systems with balanced alarm loop.

- The electric strike must be supplied with stabilized DC power, with deviations not exceeding +15 % / -10 % from the rated voltage.
- Indication bolt contact: open / closed door.
- Connections: screw terminal blocks.

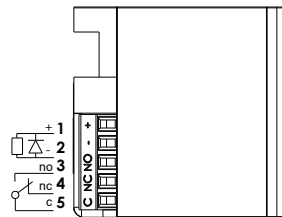

ARTICLE NUMBER

Article number	Designation
ST880	Surface mounted lock STEP 8. Fail secure function 24 V DC. Incl. hook.
ST880-12	Surface mounted lock STEP 8. Fail secure function 12 V DC. Incl. hook.
ST881	Surface mounted lock STEP 8. Fail safe function 24 V DC. Incl. hook.
ST881-12	Surface mounted lock STEP 8. Fail safe function 12 V DC. Incl. hook.
ST890	Surface mounted lock STEP 8. Fail secure function 24 V DC. Incl. hook and angle bracket with house, 90 degrees.
ST890-12	Surface mounted lock STEP 8. Fail secure function 12 V DC. Incl. hook and angle bracket with house, 90 degrees.
ST891	Surface mounted lock STEP 8. Fail safe function 24 V DC. Incl. hook and angle bracket with house, 90 degrees.
ST891-12	Surface mounted lock STEP 8. Fail safe function 12 V DC. Incl. hook and angle bracket with house, 90 degrees.

Article number	Designation accessories
ST860	Angle bracket with house, 90 degrees.
ST861	Angle brackets. Adapted for sliding doors.
ST862	Angle bracket with house, 45 degrees.
ST863	Mounting plate
ST864	Hook.
ST870	Glass fitting.
ST9088	Distance plate.



TECHNICAL INFORMATION

- Durability: Grade X per EN 14846.
- Corrosion: Grade M per EN 14846.
- Fail safe function adapted to requirements according to EN 13637.
- Microswitch unipolar changeover, max. 30 V DC, 1A.
- Built-in protective diode.
- Built-in indication for detection of whether the door is closed/open (bolt contact).
- Break resistance 9 kN (≈ 900 kg).
- Ensures opening despite preload up to 1,5 kN (≈ 150 kg) in fail secure and fail safe functions.
- Anti-hammer secured.
- Reversible to fit right- and left hung doors.
- Adapted for sliding doors.